

TL-P1 (Landscaping)



The TL-P1 holds all types of turf reinforcement matting, erosion blankets, geotextiles and landscaping fabrics securely in place

FEATURES / BENEFITS

- Up to ten times faster to install than traditional methods (e.g. J-Pin, U-Pin and wooden stakes)
- Reduces labour costs
- Superior load bearing performance compared to pins and stakes
- Helps maintain tension in the fabrics and their contact with the ground
- Minimal damage to fabric weaves, limiting weed infiltration
- Easy installation with standard electric drill and bespoke chuck



SPECIFICATION

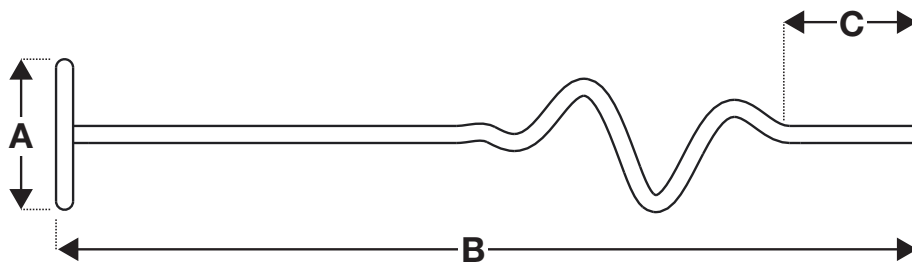

Dimension	Length (mm)
A	35
B	200
C	28

INSTALLATION TOOLS



Chuck
(90 mm)



Extended
Chuck
(490 mm)

For more information contact us or visit our website - www.gripple.com

INSTALLATION

1.

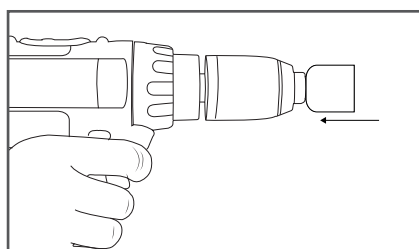

2.

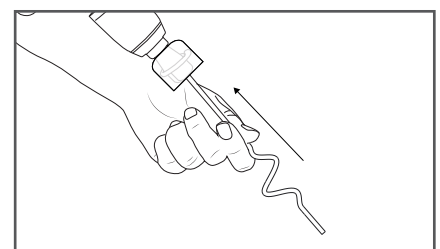

3.

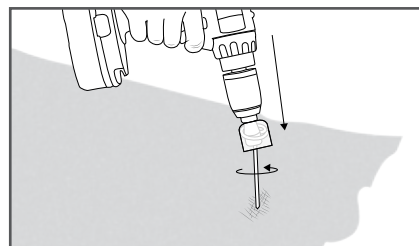

4.



For more information on how to install the TL-P1 visit our Youtube channel - GrippleTV. Alternatively see Installation Guidelines & Procedures.

CHUCK ASSEMBLY



PI-TLP1-ENG-LAN

www.gripple.com

Gripple's policy is one of continuous development and innovation. We therefore reserve the right to alter specifications, etc. without notice.

Proper considerations should be given to underground services before installing.

Gripple Ltd | The Old West Gun Works | Savile Street East | Sheffield S4 7UQ
Tel 0800 018 4264 Fax 0114 275 1155 email info@gripple.com

TL-P1 Performance (Landscaping)



The TL-P1 can be used in a variety of soils

Average Load Ratings in different soil types (kg)*

Ground Description	SPT Count	Average Load	Ground Description	SPT Count	Average Load
Dense Granular	30-50	115	Soft Clays And Silts		35
Firm To Stiff Clays		101	Loose Sand		33
Gravel		98	Very Soft Clays And Silts		23
Firm Clays		72	Sandy Clay		22
Dense Sand		58	Loose Granular	4-10	17
Soft To Firm Clays		52	Very Loose Granular	0-4	11
Medium Dense	10-30	39			

*Theoretical Loads

Resistance to pull-out versus alternate anchoring techniques (kg)*

	Install Method	Firm Clay	Clayey Sand	Firm Clay	Silty Clay	Dense Sand	Made ground (vegetated)	Loose sand	Made Ground (unvegetated)	Medium Silt
TL-P1	Combi Drill + TL-P1 Drive Tool	82.1	74	71.6	63.7	58.8	39.7	34.4	27.2	22.3
Wooden Stake (275mm / 11")	Hammer						32			
Long "J" Pin (300mm / 12")	Hammer			14.9	5.2		8.7		12.6	8.4
No.3 rebar hook (254mm /10")	Hammer		15.2					10.8		
Short "J" Pin (200mm / 8")	Hammer			5.8	3.7		6.3			4.3
Straight washer pin (610 mm / 24") ((Ga.)	Hammer		10.4					5.4		
Straight washer pin (457mm / 18") (8 Ga.)	Hammer							7.2		
Straight washer pin (457mm / 12") (8 Ga.)	Hammer		10.1							
U - Pin (170x70x6)	Hammer		9				11	3.6		

*Actual Loads

PI-TLP1-ENG-LAN

www.gripple.com

Gripple's policy is one of continuous development and innovation. We therefore reserve the right to alter specifications, etc. without notice.

Proper considerations should be given to underground services before installing.

Gripple Ltd | The Old West Gun Works | Savile Street East | Sheffield S4 7UQ
Tel 0800 018 4264 Fax 0114 275 1155 email info@gripple.com