

Hook End Fixing



For the suspension of HVAC, Mechanical, Lighting & Electrical services in an indoor stationary setting.
NOT suitable for use in chlorinated / swimming pool environments.

APPLICATION

For use with beam & purlin clips, cable basket & tray, light fixtures, or any service or clip with a 1/4" hole. Attachment to top rail of cable basket or tray should be per basket/tray manufacturer's approval.

MATERIAL

Cable: Galvanized high tensile steel cable to EN12385.
Standard lengths from 5ft-30ft, other lengths can be made to order.

	No. 1	No. 2	No. 3
Cable Dia. (in.)	1/16"	5/64"	1/8"
Strand configuration	7x7	7x7	7x7

Hook End: Zinc plated steel

* Refer to fastener load ratings and safety factors.

HOOK

Cable with crimped Hook end fixing*



SIZE SPECS

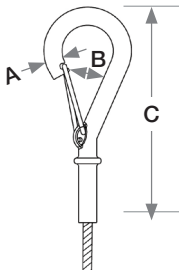

Size	A (in.)	B (in.)	C (in.)
No.1 Mini Hook	3/16"	1/4"	2 3/16"
No.1 Hook	1/4"	5/8"	3"
No.2 Hook	1/4"	5/8"	3"
No.3 Hook	1/4"	5/8"	3"

INSTALLATION

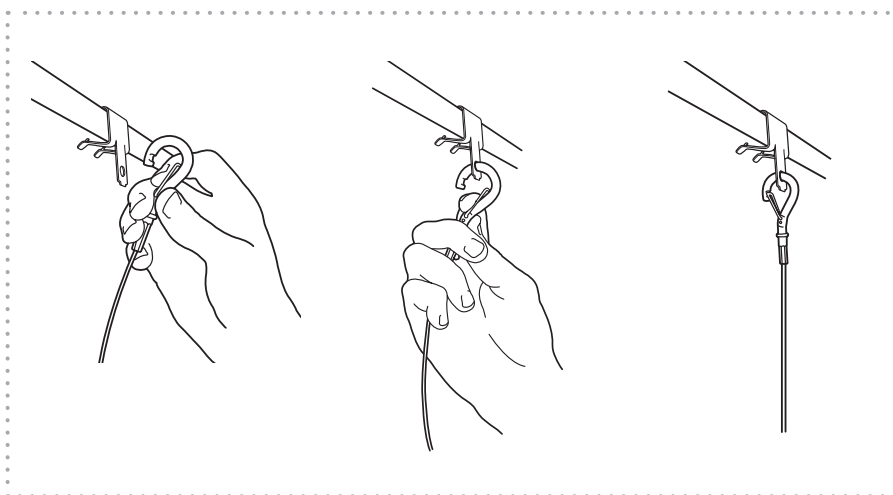

APPLICATION EXAMPLES

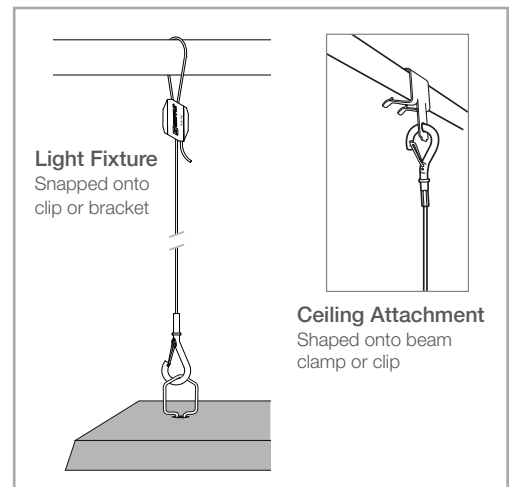

SUB-HOOK-US

www.gripple.com

Gripple's policy is one of continuous development and innovation. We therefore reserve the right to alter specifications, etc. without notice.



Gripple Inc | 1611 Emily Lane | Aurora, IL 60502 | USA

Tel +1 866 474 7753 Fax +1 800 654 0689 Email grippleinc@gripple.com