

Threaded Rod Adapter Installation



www.gripplE.com

INSTALLATION STEPS

1

Simply screw the threaded rod on to the GripplE threaded rod adapter SX-ADP.

2

Insert Threaded Rod Adapter into Spider Insert with upward force with the toggle parallel to the nails/screws

2.1 Pull rod adapter down with force 2-3 times to ensure it is set in the Spider.

2.2 If the Rod Adapter does not set, re-insert it into the Spider and rotate a quarter turn in the locking direction of the rod (the direction in which you will rotate the rod to lock it with rod adapter or nut), and pull downwards 2-3 times to ensure it sets.

- Do not rotate the rod in its unlocking direction, it may cause the rod to loosen from the rod adapter.
- Always pull downward firmly to ensure the rod is properly set before completing installation

2.3 Try to turn the rod again in its locking direction to ensure it is fully tightened into the rod adapter.

Please refer to the data sheets for safe working loads on all sizes of threaded rod adapters.

INSTALLATION ILLUSTRATION

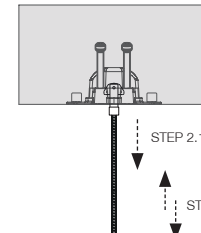
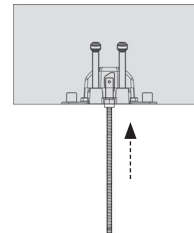
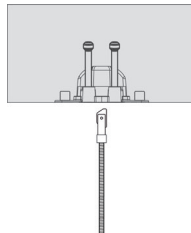
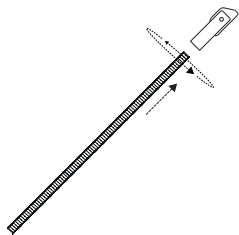

Failure to comply with these recommendations may result in product malfunction and possible damage to property or person and will invalidate the GripplE warranty. GripplE products are warranted to conform to the manufacturer's published specifications at the time of shipment and to be free from defects in materials and workmanship. No other warranty, whether express or implied, including any warranty of merchantability or fitness for purpose, shall exist in connection with the sale or use of any GripplE product.

For further technical assistance, please contact:

GripplE Inc. 1611 Emily Lane / Aurora, IL 60502 Phone: 630.406.0600 Email: gripplEinc@gripplE.com

INST-SX-ADP
www.gripplE.com

Manufacturer's Recommendations

LOADS – Always use product within its stated Safe Working Load (SWL).

LIFTING & MOVEMENT – Do not use for lifting, such as in a crane or pulley situation, or for hanging services exhibiting movement or dynamic behavior. Designed for hanging statically positioned services only.

INSTALLATION: Do not walk or stand on the GripplE product installation.

PAINTING – Do not paint the Trapeze fastener. Ensure that the fastener is in its final position prior to applying any paint to the cable assembly. Do not move fastener after painting

CABLE – Always use GripplE supplied and specified cable. Never use on coated cable or other cable. Trim any damaged filaments with GripplE wire cutters before use.

ENVIRONMENT – GripplE products, including Stainless Steel, are NOT suitable for use in chlorinated / swimming pool environments. Use standard GripplE hangers in **DRY LOCATIONS ONLY**. Stainless Steel GripplE hangers are **SUITABLE FOR DAMP LOCATIONS**.

LUBRICATION – Do not apply oil or any other lubricant to the GripplE fastener or any other part of the cable assembly.

HANGING AT AN ANGLE TO VERTICAL – Ensure that the load calculation considers the effect of 'side load'. For example, at an angle of 60° to vertical, the SWL is reduced by 50%. (See published technical information on website or in Product Guide.)

Failure to comply with these recommendations may result in product malfunction and possible damage to property or person and will invalidate the GripplE warranty. GripplE products are warranted to conform to the manufacturer's published specifications at the time of shipment and to be free from defects in materials and workmanship. No other warranty, whether express or implied, including any warranty of merchantability or fitness for purpose, shall exist in connection with the sale or use of any GripplE product.

For further technical assistance, please contact:

GripplE Inc. 1611 Emily Lane / Aurora, IL 60502 Phone: 630.406.0600 Email: gripplEinc@gripplE.com